

No. .... A-4-4 / 2389

Date. ....

2024/07/25

**Addendum No. (2)**  
**Central Tender No. (41/2024)**  
**Construction of Princess Muna Al-Hussein Maternity Hospital at**  
**King Hussein Medical Center/Royal Medical Services.**  
**Financed by the United States Agency for International Development (USAID)**

**Dear Sirs,**

You are kindly requested to download addendum No. (2) from the official website of (GTD) ([www.gtd.gov.jo](http://www.gtd.gov.jo)) or from Jordan online E-procurement system (JONEPS) which includes:

1. Employer answers for request of clarifications received by the tenderers for the subject tender **(14 pages)**.
2. Delete page no. (**Arch. Civil – 14, Arch. Civil - 86**) from BOQs and replace it with page no. (**ADD. Arch. Civil – 14, ADD. Arch. Civil - 86**).
3. Delete pages no (**5,9,10**) from evaluation criteria data sheet and replace with pages no (**ADD-5, ADD-9, ADD-10**).
4. Delete drawings no (**M 201, M 202, M 204, M 205, M 206, M 207, M 208, M 209**) and replace it with drawings no (**ADD.M 201, ADD.M 202, ADD.M 204, ADD.M 205, ADD.M 206, ADD.M 207, ADD.M 208, ADD.M 209**).
5. Attached an electronic copy includes **"Soil Test Report"**.
6. Soft copy an excel format for BOQs is attached, with noting that the (PDF) format for BOQ's must be submitted also it will be considered during the tender evaluation stage.
7. Attached an electronic copy includes **"Tender Documents in PDF format"**.
8. Attached **"Prequalification forms in word format"**.

No. .... A-4-4 / 2389

Date. ....

2024/07/25

9. Attached (4 pages) which include the Employer answers for request of clarifications received by the tenderers on the previous tender.
  10. All items in lump sum quantity shall be priced into the total price part only and the total price will be considered only.
  11. No additional clarifications or questions will be accepted or considered.
  12. The Bid Bonds that were issued in the first submission date will be accepted.
- In case of any item listed in the addendum is priced in the original BOQ and not priced on the addendum pages, the item shall be deemed included in the bid price even if the item's description or quantity remains unchanged.
  - This addendum shall be considered as an integral part of the tender documents.

Best Regards,

  
Director General  
Eng. Mahmoud Hashim Khelifat

CC: specialized central procurement committee's directorate.  
Tender File Central Tender No. (41/2024).

## Addendum No. 2

Construction of Princess Muna Al-Hussein Maternity Hospital at King Hussein  
Medical Center/Royal Medical Services.  
Financed by the United States Agency for International Development (USAID)

This addendum is considered part of the tender documents of the Central Tender  
No.:(41/2024)

This addendum shall be read as an integral part of the tender document and shall be  
signed, stamped, and submitted by the applicant along with the tender documents.

If an item listed in the addendum is priced in the original (BOQ) but not priced on the  
addendum pages, it will be considered included in the bid price, regardless of whether  
the item's description or quantity remains unchanged.

This addendum consists of three sections with a total of 18 pages.

**Section 1: Questions and Answers:** Includes the response to the inquiries received  
from all applicants.

**Section 2: Amendments to Tender Documents:** Attached are pages of documents that  
were amended.

**Section 3: Previously issued addendum for Central Tender No. 52/2023**

مدير دراسات الأبنية  
المهندسة وفاء نايف العالول

## Section 1: Questions and Answers:

No.	Question	Answer
1.	<p>The announcement mentioned that the invitation is open to international qualified and classified contractors eligible under USAID geographic code 937.</p> <p>We understood that only contractors registered in the countries mentioned in the attached list are allowed to participate.</p> <p>i.e. it's not allowed to participate for Contractors from UAE.</p> <p>Please confirm our understanding.</p>	Yes, confirmed.
2.	Please postpone the bid submission deadline by three weeks, so that it becomes August 18 instead of July 24, allowing us sufficient time to study and submit the best price offers for the execution of the above-mentioned project.	Refer to Addendum No.1
3.	Kindly provide us with the Excel BOQ format just for pricing not for submission.	Attached is the Excel BOQ for pricing purposes only and not for submission
4.	Kindly provide us with the soil report.	Attached is the soil report.
5.	Please provide us with Volume 5 as mentioned in the tender documents, as it is not available on the Government Tenders Department website or the JONEPS website	<p>Tender Documents for this Contract consist of the following five volumes:</p> <ol style="list-style-type: none"> <li>1. Volume 0: Pre-Qualification for the Construction of Healthcare Facilities/ Instruction to Applicants &amp; Forms</li> <li>2. Volume 1: Invitation, Forms and Contract Conditions</li> <li>3. Volume 2: Technical Specifications</li> <li>4. Volume 3: Bill of Quantities</li> <li>5. Volume 4: Drawings</li> </ol> <p>All the aforementioned volumes are available on the Government Tenders Department website and the JONEPS website.</p>
6.	Regarding the countries allowed for import for the above project, please clarify whether Chinese origin is acceptable or not. And is China on the list of countries that the USAID funder approves of dealing with	The materials of Chinese, European...etc. Origin might be accepted if they meet the project's technical specifications, and they might be exempted if conditions of exemption are achieved, in compliance with USAID 937 source requirements, and as illustrated in the Pre-Bid conference.

No.	Question	Answer
7.	Please provide us with the tender documents in searchable PDF format instead of scanned PDF to facilitate information retrieval through searching.	Attached are the tender documents in PDF format.
8.	You are kindly requested to provide us with an electronic copy in Word format of the qualification forms for the above mentioned project.	The forms required to be filled out by the contractors are attached in Word format.
9.	You are kindly requested to extend the bid submission date for at least two weeks.	Refer to Addendum No.1
10.	Is the contractor who was previously qualified for the above project considered qualified, or does he have to re-submit the qualification document again?	All interested contractors must submit the requested prequalification documents. Prequalification for past USAID projects, even this one, does not automatically qualify you for this specific project.
11.	Please postpone the submission of the above project for no less than three weeks.	Refer to Addendum No.1
12.	Provide us with the vendor list.	There is no Vendor list for this project.
13.	Regarding USAID Code 937, please advise if Chinese suppliers and Manufacturers are considered qualified suppliers or not.	Refer to answer No.6
14.	Is the night work allowed for the contractor awarded the above tender?	Please abide by what is mentioned in Volume 1/Contract Conditions/Conditions of Particular Application/ Sub-Clause 45.1 - Restriction on Working Hours.
15.	Please postpone the inquiries period one week allowing us sufficient time to study the project and submit the questions.	Refer to Addendum No.1
16.	Please provide us with the project drawings in AutoCAD and searchable PDF format.	<ul style="list-style-type: none"> <li>• The winning tenderer can coordinate with MPWH to get a copy of the drawings in DWG format.</li> <li>• Attached are the drawings in PDF format.</li> </ul>
17.	Please provide us with the As-Built drawings related to the infra-MEP services passing through the project boundary.	<p>There are no As-Built drawings available for the infra-MEP services within the project boundary. The only existing documentation related to the site is the topography plan, which has been included in the tender documents. Please note that all available information has been provided in the bid documents.</p> <p>Please refer to Architectural Drawings/Demolition Site Plan A101, and Volume 1/Contract Conditions/ Article 2.4</p>

No.	Question	Answer
		"Examination of Tender Documents and Sites"
18.	Please provide us with any PTW (Permit to Work) procedures related to the project accessibility.	The PTW (Permit to Work) procedures related to project accessibility will be developed and finalized in coordination with the project engineer and the project owner after the awarding of the project. These procedures will be communicated to the successful bidder at that time to ensure compliance with all project requirements.
19.	Please provide us with the Q&A (Questions and Answers) related to the previous tendering stage.	Attached are the Questions and Answers related to the previous tendering stage.
20.	We kindly request that you cancel the duration limit of 15 years for the past performance record for projects of a similar nature.	Attached is the amended Evaluation criteria data sheet.
21.	Reconsider the allocation of evaluation points (especially for building works scope), ensuring that completed hotel or mall projects receive similar weight to Hospital projects.	Attached is the amended Evaluation criteria data sheet.
22.	Please provide us with the drawings in the AutoCAD Format to facilitate the process of studying and analyzing the Tender.	The winning tenderer can coordinate with MPWH to get a copy of the drawings in DWG format.
23.	It is mentioned in the contract that the tender is exempted from all taxes except income taxes, what about stamp duties (.006*tender price)?	The project is exempted from stamp duties. Please refer to the attached letter with this addendum.
24.	Are the contract prices adjusted for rises or falls in the cost of materials? And does the circular of the Ministry of Public Works in this regard are applicable, or not?	Please refer to Volume 1- Part II - Conditions of Particular Application – Section 6- Sub Clause 70.1.
25.	Can the materials of Chinese origin be approved for the project?	Refer to answer No.6
26.	Can American and European brands with Chinese origin be approved for the project materials?	Refer to answer No.6
27.	With reference to item No. (3/6) Of the structural works of the BoQ, should the item price include a double brick with a lead layer? Please clarify.	The item includes the lead layer with its related works, the block works shall be calculated following item No. (3/3) of the structural works in the BoQ.
28.	Please clarify the source of the requested masonry stone in the tender documents, because Jerusalem masonry stone includes many types and varieties; In addition to	The required stone matches the "Taffouh stone" best quality and is free from any defects.



No.	Question	Answer
	that, there is a huge difference in prices among them such as "Beit Fajjar Stone" and "Taffouh stone"	
29.	It was noted that the type of stone covering the building adjacent to the project, which is the Queen Rania Hospital for Children, is Taffouh stone. Should a stone similar to the existing building be installed in the color and type of Taffouh stone for the project?	Refer to answer No.28
30.	<p>After reviewing the qualification criteria for the above bid, we kindly request your agreement and consideration regarding the grading system. We propose redistributing it in a manner that ensures access to qualified contractors with good reputations, allowing them to enter and compete in the tender. The contractor's prior experiences with USAID projects should be considered, as this can enhance their qualifications and provide an opportunity to offset any loss of marks by submitting similar projects.</p> <p>We have executed several projects under SKEP 2 and SKEP 3 for USAID, with an estimated value of approximately 16,000,000 JD. Each project covered an area of no less than 16,000 M2, featuring high-quality specifications and advanced mechanical and electrical systems. These projects were completed on schedule without any issues with the employer or USAID.</p> <p>Additionally, we have undertaken industrial projects with a high level of preparation and implementation, utilizing modern and advanced systems. This includes food manufacturing factories such as the Canary Factory in Amman, the Matte Factory in Salt, and the Green Hass Fertilizer Factory in Mafraq.</p>	The contractor's prior experiences with USAID projects are not considered additional marks or bonuses in the evaluation process.
31.	<p>Regarding the project mentioned above, please provide us with answers to the following inquiries:</p> <p>Please confirm that the required Key Staff in the prequalification is just the head office key staff and that the work team details needed for the project will be provided by the main contractor who wins the bid.</p>	Yes, confirmed.
32.	What is the minimum score required to pass the evaluation?	The minimum score to pass the technical evaluation will be determined by the GTD in full coordination with USAID.
33.	Please provide us with the procedure that will be followed to exempt the materials from customs when supplying the materials through local suppliers noting	<p>Regarding the exemption procedure, kindly be informed of the following:</p> <p>1. All local on shelf items are exempted from sales taxes. Invoices with zero taxes shall</p>

No.	Question	Answer
	that the materials will be invoiced in the main supplier's name.	<p>be approved by the Engineer and then will be stamped by USAID.</p> <p>2. For the imported materials:</p> <ul style="list-style-type: none"> <li>• If the contractor imported the materials himself not through the local suppliers, the materials might be exempted if conditions of exemption are satisfied, in compliance with USAID 937 source requirements.</li> <li>• If the contractor imported the materials through local suppliers who usually import such materials, but the suppliers do not have sufficient quantity at that moment to fill the complete order and must import more units from outside Jordan, the materials will be exempted.</li> <li>• The Contractor will submit the request to the Engineer, and then USAID will issue the exemption letter specific to the Imported material.</li> </ul>
34.	<p>Are Materials of European origin will be approved or not? As such origins are not mentioned in the "code 937-advance developing countries list"?</p> <p>And since all materials available in Jordan are following IEC standards which are from European brands and Countries of Origins</p>	Please refer to answer No.6.
35.	<p>Kindly note that in the instructions to applicants, specifically under item 3.2.a, it was stipulated that the Average Annual Turnover requirement for Local Jordanian Contractors should be equal to or exceed 5,000,000 JD. Similarly, under item 3.2.c, the requirement for International Contractors was set at 7,000,000 USD, which equates to 5,000,000 JD.</p> <p>Additionally, Item 3.2.b mandates that the Average Annual Turnover for each party in a Joint Venture (JV) must be equal to or greater than 5,000,000 JD.</p> <p>You are kindly requested to reconsider the requirement stipulating that the JV companies must collectively meet the Average Annual Turnover requirement of 5,000,000 JD and not for each.</p>	<p>The combined average annual turnover for the joint venture (JV) shall be greater than or equal to 5,000,000.00 JD, with the JV leader contributing 60% and the electromechanical part contributing 40%</p> <p>Attached is the amended page.</p>
36.	Please extend the inquiry period.	Please abide by the date mentioned in Addendum No. 1



No.	Question	Answer
37.	Please confirm that the project is exempted from sales tax completely	The Works performed under this Contract shall be exempted from customs and sales taxes if conditions of exemption are achieved. Please refer to clause 74 in the Contract Condition.
38.	In order to ensure the submission of comprehensive technical and financial proposals, we kindly request an extension of the clarification period by one week and an extension of the tender submission deadline by three weeks.	Refer to Addendum no.1
39.	There is no mention for the kitchen and laundry equipment in the BoQ, please confirm that the kitchen and laundry equipment are not required by the contractor.	These works are out of the contractor's scope.
40.	The firefighting drawing shows that the system includes "Zone Control Valves". However, The BoQ does not include any item such valve. Please clarify whether Zone Control Valves are required by the contractor or not.	Yes, they are required by the contractor as mentioned by valves included in the firefighting pipes item, please refer to (12/4/5) item, Fire Fighting Pipes (Pipes shall include all fittings, hangers, flanges, supports, all kinds of valves)
41.	The firefighting drawing show that the system includes "Alarm Check Valves". However, The BoQ does not include any item such valve. Please clarify whether Alarm Check Valves are required by the contractor or not.	Yes, they are required by the contractor as mentioned by valves included in the firefighting pipes item, please refer to (12/4/5) item, Fire Fighting Pipes (Pipes shall include all fittings, hangers, flanges, supports, all kinds of valves)
42.	In regards for synchronizing panels; the commonly used standards in Jordan and which is already shelf items safety and technical aspects are IEC, please confirm the use of IEC as standards for the said panels.	Please abide by project technical specifications.
43.	Referring to capacitor bank specs, it is following NEMA standards, and commonly used in Jordan are IEC standards power factor banks, and it makes it easier for the owner in maintenance and spare parts, please confirm.	Please abide by project technical specifications.
44.	Please confirm under item 11/27 electrical works the only scope required is the second fix despite the item description starting with supply and install horizontal bed head unit etc...	With reference to item (11/27) Bed Head Unit: 1. The contractor is responsible to supply, install, test, and commissioning of BHU

No.	Question	Answer
		<p>second fix that means include conduits, conduits fittings, pull boxes, back boxes , accessories and circuit wiring or cables (4mm<sup>2</sup>) in PVC conduits for power socket outlets between bed head unit main junction terminal point up to its sub-panel board and wiring or cables (2.5mm<sup>2</sup>) in PVC conduit for lighting in bed head units up to its sub-panel board ,cat 6a cable in PVC conduits for RJ45 data outlet in BHU up to patch panel, and nurse call system outlets inside the BHU, and all necessary materials, accessories and any required works whatsoever.as per the specifications and drawings.</p> <p>2. The BHU, Pendent, WC and NP themselves are not required in the contractor's scope.</p> <p>It is not required in the contractor's scope.</p>
45.	<p>With reference to item (11/12/4) of the electrical BOQ - Supply, install, connect, test, and commission " surgical light point No. 4 ", However, the BOQ did not include any item for supplying and installing any surgical lights. Please confirm that supplying and installing the surgical lights is not required by the contractor,</p>	<p>The Surgical lights are not required in the contractor's scope.</p>
46.	<p>With reference to item (11/19) of the electrical BOQ - TV system, please clarify the following:</p> <p>a) Please specify the type of the TV system required, is it SAMTV or IPTV?</p> <p>b) In the IPTV specs, it is mentioned that the system includes an IP set Top Box. However, there is no mention for these boxes in the BOQ. Please clarify whether these boxes are required by the contractor or not.</p> <p>c) Regarding items (11/19/B, C) - IPTV wall mounted and ceiling, should the price include supplying and installing (32" LED screens) or not?</p>	<p>A. The TV system that is required is IPTV.</p> <p>B. The contractor is responsible for submitting a fully operational IPTV system that works with all its components according to Specifications, Drawings, and BOQ.</p> <p>C. The contractor is responsible for supplying and installing LED screens 32".</p> <p><b>Specification of 32" LED Screen:</b>  Model: Well Known Brand Name.  Interface:  <ul style="list-style-type: none"> <li>• 2 x HDMI</li> <li>• 1 x USB</li> <li>• 1 x AV (composite)</li> <li>• 2 x LAN (RJ-45)</li> </ul> Full HD: Yes</p>

No.	Question	Answer
		Aspect Ratio: 16:9, Just Scan, Set by Program, 4:3, Zoom Bracket: Wall/ceiling Mount Bracket
47.	With reference to Item (11/24) of the electrical BOQ - Public Address\Voice Evacuation System, the BOQ does not include any item installing feeding points for the speakers, please clarify.	The Public Address\Voice Evacuation System has already included the Loudspeakers, however, the contractor is responsible for supplying, installing, testing, and commissioning of PA/VE system, and note that the system is UL listed.
48.	With reference to Item (11/29) of the electrical BOQ - Elevators, please note that as per the tender drawings and BOQ, the elevator shaft serves multi elevators without any partition between the elevators, although such partitions are necessary for installing and fixing the elevators. Is the contractor required to supply and install such partitions? And should they be included in the item price? Please clarify.	It is required to add steel separation beams between the elevator inside the shaft, as part of the supporting system and fixation required from the contractor.
49.	Following the conference meeting on July 11, 2024, and with reference to the pre-qualification evaluation criteria, please note that the criteria outlined in the tender documents allocate a 60% weight to the past performance of similar hospital projects. This emphasis on hospital project experience will significantly limit the number of contractors who can meet this requirement, given the limited availability of such projects in our country.  Therefore, we propose that mall projects, food factories, and unique projects like Teleferique and Water Parks, among others, be given the same weight given to hospital projects due to their similar complexity.	Refer to answer no.21
50.	Contract conditions have stated that Geographic Code 937 applies to this tender. Could you explain how the employer will deal with commodities and services provided/supplied by local suppliers for end products with raw materials not within Geographic Code 937, for example, Aluminum sections, doors hardware, etc	Refer to answer no.33
51.	Kindly provide us with a list of approved manufacturers as we are facing difficulties in obtaining some materials as there are no Jordanian agents that can obtain the required materials in accordance with Code 937	Refer to answer no.12
52.	All major Items in the Specs follow BS & IEC codes, this means we will face difficulties in obtaining materials in accordance with Code 937, so please confirm the	Refer to answers no.6 & no.33

No.	Question	Answer
	possibility of obtaining materials from countries such as Europe & China.	
53.	Please provide us with an extension for Bid submission for at least 14 working days.	Refer to addendum no.1
54.	Kindly note that the COC refers to FIDIC 1987 4th Edition, while the practice in Jordan now is the FIDIC 1999, please accept to amend to be according to FIDIC 1999 or after.	Please abide by the project requirements.
55.	Reference to the Instructions to Tenderers Article 2.13 (Currency & payments) and to Part I, II conditions of contract clauses 60, 72.1, 74.2 that refer to taxes, duties & customs, kindly confirm that the project is ZERO sales Tax, Customs & duties exempted.	Refer to answer no.37.
56.	Civil & Architectural specifications, page 37 – (Terrazzo Tiles – Testing) please clarify the point a- Water absorption – not more than 4kg/m2	The terrazzo tiles shall comply with "Jordanian standard specification 45-1/2009".
57.	Details for laboratories, Nurse stations & cabinets are found on drawings while there are no BOQ items for them, please advise if included in our scope of work or not.	These works are out of the contractor's scope, but the contractor shall make all necessary preparations (Architectural, Civil, Electrical, and Mechanical works) to prepare the location for installation works. Additionally, the contractor shall collaborate with any relevant parties as instructed by the Engineer to ensure the successful completion of the works.
58.	Details for the Kitchen & Laundry are found on drawings while there are no BOQ items for them, please advise if included in our scope of work or not.	These works are out of the contractor's scope.
59.	Please note that Doors Hardware set schedules are said to be of American origin while specifications state a European origin, please confirm that both are accepted.	Please abide by the requirements mentioned in the Hardware schedule, and in case of contradictions, European specification shall take precedence.
60.	Kindly confirm that Ceiling C-05, suspended ceilings 12.5mm thick is painted with antibacterial hygienic epoxy paint as stated on drawing # A913 Finishes Schedules & T.D Details 1 of 2.	Yes, confirmed.
61.	BOQ section Item 2/11 "4mm thick bituminous membrane with a slate chip finish for basement walls", please confirm that it has to be with a slate chip.	The bituminous waterproofing membrane for basement walls shall be without the slate chip. Attached is the amended page
62.	BOQ section 8- Item 8/5 Antibacterial paint, in the price inclusions, is said to be three layers of emulsion coats,	Yes, confirmed that for Item no.8/4 not 8/5 as mentioned, the paint shall be epoxy with

No.	Question	Answer
	which contradicts with main description, please confirm that it shall be epoxy paint with a total thickness of 300 microns for all layers.	a total thickness of 300 microns for all layers. Attached is the amended page.
63.	At 4th floor- operation theaters (O. T), kindly advise if the finishes of these rooms are under the contractor's scope of work, if yes please provide the following: a. The wall finishing is shown as a plaster with paint will there be any paneling for them, if yes please provide specifications & details. b. Door D09 for the O.T Shown as a hermetical sealed door 60mm thick and the fascia finish with HPL laminate finish, kindly advise the specifications for the HPL, also advise if the door is automatic or manual, c. Details for Light, laminar flow, pass box, and other related items are not available, please provide.	Yes, the finishes of these rooms are under the contractor's scope of work, and kindly be informed of the following: a. Regarding the wall finishing, please abide by what is mentioned in the design drawings and tender documents. b. Regarding Door D9, the door shall be an automatic sliding door, and controlled by a (hand/elbow) from outside and inside in case of a power outage. Regarding HPL, please refer to Volume 2/Technical Specifications/SECTION – 11 WOOD WORKS/page 57 c. The Surgical lights are not required in the contractor's scope, and for the remaining items please refer to the Design drawings and tender documents, all needed works are mentioned.
64.	Regarding Elevators, dump waiters & Passenger Lifts, we contacted the suppliers and factories, please note that in Jordan the code followed is British and European standards, so please confirm that Chinese or European Manufacturers are applicable.	Refer to answer No.6.
65.	The surgical control panel didn't show up in any drawing please provide more details.	For the Surgical control panel location refer to drawing #E209A "FOURTH FLOOR POWER SYSTEM", they are distributed in the C/S Operation theater room. For the Surgical control panel detail refer to E002 "BED HEAD UNIT DETAILS"
66.	To confirm that Bed head Units are only 1st and 2nd fix only	Refer to answer No.44.
67.	Kindly advise if the configuration of the medical gas outlets will be according to the drawings or HTM 02-01 guidelines.	Gas outlet configuration is required according to the design drawings and room by room which are requested & approved by the client.
68.	Kindly note that N2O is present in the LDR room, while AGS is absent kindly clarify.	N2O in the LDR is required only to be <u>mixed with O2</u> . So, no need for AGSS because it will not be used alone as N2O.
69.	According to BOQ item 12/3/16 we need more detail about FCU On/Off coil air temperatures (Cooling and Heating) and the heating coil is missing.	• Air on/off coil temperatures for Cooling coil are (23.5-24) °C / (13-13.5) °C.

No.	Question	Answer
		<ul style="list-style-type: none"> <li>Air on/off coil temperatures for the Heating coil are (21.5-22) °C / (30-33) °C. The required FCU is double coil type (Cooling &amp; Heating) according to the drawings &amp; schedules, where the heating coil for FCU is mentioned on the unit's schedule which shows water flow rates &amp; hot water on/off coil temperatures.</li> </ul>
70.	Due to the challenges & difficulties of obtaining quotes that meet Code 937, the time provided to Contractors is limited and we will not be able to provide the prices in a healthy manner. In order to obtain and provide competitive prices, please arrange for an extension of at least two months as a minimum.	Please abide by the date mentioned in Addendum No. 1.
71.	With Reference to BOQ, Section (7): Aluminum, Glass & Steel Works Item 7/14, kindly note that there are no drawings for the Poly-Carbonate Sheets (Lexan Canopy), please provide us with drawings for the canopy.	Please refer to Architectural Plan A-602, detail No.D06, Section C-C.
72.	The technical specifications for the hardware sets differ from the drawings. Please specify what to follow.	Refer to answer No.59
73.	The BOQ does not include any items for the Counter & Nurse Station Details shown in the Architectural Drawings, A615 to A617, please clarify.	Refer to answer No.57
74.	Regarding Fire Alarm System Smoke detectors: what is the number of level sensitivity required for the smoke detector and what is the range of it?	The number of level sensitivity shall be as mentioned in the specification "The sensors shall have several selectable sensitivity levels ranging programmed and monitored from the FACP".
75.	What is the size of the LCD Display of the fire alarm panel?	The display screen shall have a minimum 7-inch color touchscreen.
76.	What is the size of the cable that feeds 24 VDC to the Flashers?	2.5 mm cable 950C fire resistance minimum 2 hours in a PVC Conduit 025mm.
77.	Which countries we are allowed to supply from?	Please refer to Volume 1/ Contract Conditions/ Part II - Conditions of Particular Application – Section 6/ Clause 78 Commodities and Services - Source, Nationality, and Delivery.
78.	Is Mexico from the accepted countries, in accordance to Geographical code 937?	The materials of Mexico origin might be accepted if they meet the project's technical specifications, and they might be exempted if conditions of exemption are achieved, in compliance with USAID 937 source



No.	Question	Answer
		requirements, as illustrated in the Pre-Bid conference.
79.	What is the required Mechanism for the slave clocks Sync wired or impulse?	The required mechanism for the slave clocks is Synch wired such as AFNOR Protocol or Equivalent.
80.	In accordance with Code 937 Material sources are limited to the USA, Jordan, India Egypt, and other countries listed in geographical code 937, In reference to this Code and the specifications provided by the consultant, it is likely that we will have difficulty obtaining materials in accordance with this geographical code. Please confirm that European sources are approved in accordance with Geographical Code 935	Refer to answers No.6 & No.33
81.	Elevator & Dump walter Suppliers from the US were contacted by Jordanian Contractors, and we faced rejection in pricing the materials from the USA, so please confirm the availability of obtaining such materials from China and or European origins.	Refer to answers No.6 & No.33
82.	Please advise that Bus Way duct to follow BS and IEC standards instead of UL and NEMA standards, please advise that we can follow IEC & BS standards for this item, and also bear in mind that the Quantities are minimum in regard to Bust Dust Suppliers.	Please abide by project technical specifications,
83.	Please confirm that the Generator, Synchronizing Panel, Power factor panel & ATS Panels to follow IEC standards instead of IEC since they are the used standards within Jordan and are easier to obtain and maintain	Please abide by project technical specifications,
84.	Please confirm that we can supply Bus Ducts in accordance to latest IEC and British standards instead of Nema and UL	Please abide by project technical specifications,
85.	About the Mechanical Drawing for the Drainage System as shown in the general note the vent pipe under the tile is 80 mm, while there is no item for Pipe 80 mm in the BOQ.	The sentence should read as follows "The vent pipe under tiles is 110 mm"  Attached is the amended drawing

## SECTION 2: Amendments to Tender Documents:

Replace the mentioned below pages from the Tender documents with the amended attached pages:

- **Volume 0- Prequalification Document**

1. Replace page 5 with the amended attached page ADD-5.
2. Replace page 9 with the amended attached page ADD-9.
3. Replace page 10 with the amended attached page ADD-10.

- **Volume 3- Bill of Quantities**

1. Replace page Arch. Civil - 14 with amended attached page ADD.Arch. Civil - 14.
2. Replace page Arch. Civil - 86 with amended attached page ADD.Arch. Civil - 86.

- **Volume 4- Drawings**

1. Replace Mech Drawing No,M 201 with amended attached page ADD.M 201.
2. Replace Mech Drawings No. (M 202- M 209) with amended attached pages (ADD.M 202-Add.M 209).



### SECTION 3: Previously issued addendum for Central Tender No. 52/2023:

No.	Question	Answer
1.	Reference to Sections 2,3, and 10 in the Bill of Quantities for concrete works, please clarify what is the concrete strength to be used if cube or cylinder.	Cubic Concrete Strength shall be used.
2.	Please provide us with existing plans or the quantities for internal demolition items.	Please refer to the Arch. Plan No.A205 and BOQ item No. 1/2 regarding the subject.
3.	Reference to BOQ item 3/8, page 21, the required stone thickness is 4cm, but the same item description requires compliance with Circular 117- the year 2023 ( included in the specifications on page 112/483), which states that the minimum stone thickness should be 5 cm. please advise the required stone thickness.	The required stone thickness for elevation is 4cm.
4.	Ref. Dwg A100a.1, kindly confirm if the diversion road along with sidewalks is within the contractor's scope of work, or will the client provide it, knowing that it is outside the project site boundary.	Yes, confirmed the works are within the contractor's scope of work.
5.	Ref. Dwg A100a.2, kindly confirm if the temporary parking to be added instead of the detour area is within the contractors' scope of work along with the access road, and if so, kindly provide a description and specification of the required (road layers, road marking, curbstone, etc..) along with approximate quantities. Also, please clarify if the "Temporary Parking" is to be removed by the contractor at the end of the project or if will it remain in place. We propose to introduce a Provisional Sum Item for this scope due to a lack of clarity and time.	Yes, confirmed the works are within the contractor's scope of work.  For the required area Please refer to the Arch. Plan No. A100a2 and item No. 26. H on the supplemental particular condition page no 6-85.  The Temporary Parking shall not be removed by the contractor at the end of the project and shall remain in place.
6.	It is stated in item no 26. H on the supplemental particular condition page no 6-44 "the contractor and at his own expense and before demolishing the asphalted areas located at the construction works limit, shall complete all the preparation works for the area shown in the mobilization plan to receive all required layers or only the MC layer and as per engineer instruction....' Please confirm that the (MC) parking yard to be added is	Confirmed, the (MC) parking yard to be added is located within the King Hussein Medical City staff's temporary parking.  For the required area Please refer to the Arch. Plan No.A100a2

No.	Question	Answer
	located within the King Hussein Medical City staff's temporary parking and confirm the area for new parking	
7.	With reference to the appendix to the form of tender where it is mentioned that the contractors should construct a fully furnished mockup room in order to achieve milestone No.1 (site clearance and engineer works -120 Days), please clarify the following: a. Please provide us with the location and dimensions of this room. b. Please specify what type of work should this room include (Civil, architectural, mechanical, electrical, medical). c. Please specify what type of materials should this room include.	Please refer to Volume 1- Part II - Conditions of Particular Application – Section 6 paragraph No.15., which includes all details related to the project mockup room.
8.	Request for shoring system design and shoring quantities	Please refer to Volume 2 – Technical Specifications - Section –2 regarding shoring works requirements, while the quantity will depend on the soil properties, laboratory soil report recommendations, Engineers' instructions, and approvals.
9.	The drawings show that there are stainless steel grates in the kitchen and laundry areas. However, the BoQ does not include any such item, please confirm that the stainless-steel grates in the kitchen and laundry are not required by the contractor.	These works are out of the contractor's scope.
10.	Reference to the Mechanical BOQ Page No. MECH-22, please confirm that the mentioned diameter for the CPVC Pipes Are Outer Diameter.	The sizes in the BoQ refer to the nominal Diameter.
11.	بنود جداول الكميات تشمل فقط الصحن اللاقطة والشاشات ٣٢ انش head end servers and software STB boxes ولا يوجد لها بنود في جداول الكميات	With reference to item 11/19 SMATV: the contractor is responsible for submitting a fully operational IPTV system that works with all its components according to Specification, Drawings, and BOQ.
12.	البند رقم F صفحه رقم 7-ELEC من جدول الكميات: - البند G من المواصفات الكهربائية صفحه E-74 هل يعني شرط توريد اللوحة من نفس المصنع المورد للمولدات الاحتياطية.	With reference to item 11/1-F:

No.	Question	Answer
	<p>- هل يمكن توريد اللوحة من نفس المصنع المعتمد لتجميع اللوحات الكهربائية (LOCAL PANEL BUILDER).</p> <p>- المواصفة رقم 3.3-A WITNESS TEST: هل مطلوب حضور الفحوصات من قبل ممثل المهندس وممثل المالك.</p>	<p>1. Item 1.3-G: The Synchronize panel and the generators shall be supplied from the same manufacturer in full Package.</p> <p>2. Referring to the specification: The Synchronizing Panel shall be factory tested prior to delivery to the purchaser with the mentioned tests in the specifications, so it is not allowed to be supplied from a local panel builder.</p> <p>3. It is required to provide the project engineer, site engineer, and owner with the original factory acceptance test before shipping for the supplied synchronized panel and gen set, in addition to that a local witness test should be performed to cover the entire system.</p>
13.	<p>Is the witness test required for the following electrical equipment? Panel Boards (MDB, SMDB, DB, MCC... etc)</p> <p>a. Synchronizing Panel.</p> <p>b. Diesel Generator.</p> <p>c. Patient Bed and Passenger Elevators.</p> <p>d. UPS.</p> <p>Fire Detection and Fire Alarm System</p>	<p>Wherever mentioned the witness test that means: "It is required to provide the project engineer, site engineer, and owner with the original factory acceptance test before shipping for the supplied, in addition to that a local witness test should be performed to covering the entire system."</p>
14.	<p>البند رقم 11/30 POWER FACTOR CORRECTION .</p> <p>المواصفات تنص على تقديم النظام حسب المواصفات الأمريكية، هل تقديم النظام حسب المواصفات الأوروبية مقبول.</p>	<p>It is required to comply with the specifications.</p>
15.	<p>البند رقم 11/5-A المولدات:</p> <p>تنص المواصفة على تقديم المولدات حسب IBC Seismic Certification هل المقصود أن يتم تركيب المولدات على قواعد تحقق المواصفة (BC Seismic Certification) أم تقديم شهاده من المصنع للمولدات.</p>	<p>1. The Contractor shall provide the IBC Seismic certification with all data sheets and catalogs.</p> <p>2. Refer to 3.1-D in specification: Quote "Equipment shall be installed on concrete housekeeping pads. Equipment shall be permanently fastened to the pad in accordance with the manufacturer's instructions and seismic requirements of the site."</p>

No.	Question	Answer
16.	<p>البند رقم 11/5-8 مفاتيح التحويل الأتوماتيكية ATS</p> <p>المواصفات تلص على التقديم حسب المواصفات الأمريكية هل يمكن تقديم المعدات حسب المواصفات الأوروبية وهل مطلوب تقديم شهادات Seismic للمعدات من نفس المصنع.</p>	<p>1. It is required to comply with the specifications.</p> <p>2. Regarding specification 1.3 Certifications: The Seismic Qualified to IBC-2009 and IEEE 693-2005 is required.</p> <p>Also, note that the ATS and bypass/isolation switch and related control panels shall be from one source from a single manufacturer.</p>
17.	<p>البند رقم 11/15 DATA SYSTEM:</p> <p>هل الـ EDGE SWITCHES مطلوب تقديمه من ضمن الكابائن سواء</p> <p>( حيث ان محتويات المخططات تشمل هذه HC وكابائن DC ) كابائن الأجهزة ووصف البند لا يشمل ذلك، يرجى التوضيح وفي حال كانت مطلوبة، يرجى تزويدنا بالمواصفات الفنية للأجهزة.</p>	<p>The Edge switches are not required in the contractor's scope.</p>
18.	<p>البند رقم 11/21:</p> <p>DATA سيتم تركيبها ضمن الـ POE SWITCHES (9+8) البند ارقام RACKS. يرجى التأكد.</p>	<p>The POE switches for the Surveillance System are required in the contractor's scope to make sure the CCTV system is fully operational.</p>



## Request for Prequalification

### 3. Financial Eligibility Conditions and Average Annual Turnover (Go or No Go):

3.1 All applicants are required to provide a letter from an approved local bank in Jordan for local applicants with the amounts as per Form 4/a/1 or Form 4/a/2. As for international applicants, their letter shall be back-to-back with a local approved Jordanian bank with the amounts as per Form 4/b/1 or Form 4/b/2, considering USAID Authorized Geographic Code 937 regarding the nationality of the bank. The applicants shall abide by the information submitted within this form and hold all the responsibility regarding it. Failing to submit the required Certificate of Solvency will lead to the rejection of the submission.

3.2. The applicant shall attach copies of the audited financial statements regarding their Average Annual Turnover for the last 4 years (2019-2020-2021-2022) and the highest three years will be considered, complying with the following conditions (Failing to submit Average Annual Turnover for the last 4 years will lead to the rejection of the submission):

- a. For Local Jordanian construction contractors classified first grade as per the GTD classification in the field of Building Construction, and have a first grade in electromechanical and renewable energy works, the Average Annual Turnover shall be greater than or equal to 5,000,000.00 (JD). (Form 5/a).
- b. For Local Jordanian construction contractors classified first grade as per the GTD classification in the field of Building Construction, in a joint venture with electromechanical and renewable energy contractors, of the first-grade classification by the GTD, the combined average annual turnover for the joint venture (JV) shall be greater than or equal to 5,000,000.00 JD, with the JV leader contributing 60% and the electromechanical part contributing 40%. (Form 5/a)
- c. For International qualified and classified contractors eligible under USAID Geographic Code 937, those contractors shall satisfy the qualification criteria mentioned in this document, the Average Annual Turnover shall be greater than or equal to 7,000,000.00 (USD). (Form 5/b).
- d. Applicants are required to complete Form 5/a for Jordanian applicants, and International applicants are required to complete Form 5/b.
- e. All attached financial statements must be certified and stamped by a certified public accountant, and a copy of the certificate of accreditation of the certified public accountant issued by the "Jordanian Association of Certified Accountants" must be attached for Jordanian contractors. As for the International Contractor, the same certificate from the Association of Certified Accountants in their respective country must be submitted.
- f. Historic financial statements must correspond to accounting periods already completed and audited. No statements for partial periods shall be accepted.

### 4. Preparation of the Pre-Qualification:

- 4.1. Information shall be submitted in the format specified in the pre-qualification forms included with these documents.
- 4.2. In the case of a joint venture, the pre-qualification forms shall be completed as indicated under these documents (Form 1/b, Form 2/b).
- 4.3. JV members shall provide a preliminary JV agreement form signed and stamped by both parties (Form 7).
- 4.4. The allowable number of JV parties is two, and an application with a JV consisting of more than two parties will be rejected.
- 4.5. The pre-qualification documents shall consist of the following:

ADD-5

مدير دراسات الأبنية  
المهندسة وهاء نايف العالول

مدير دراسات الأبنية  
المهندسة وهاء نايف العالول

# Request for Prequalification

2	Past Performance of the main contractor and electromechanical and renewable energy contractor (for JV)	60	<p>Specific criteria include:</p> <p>Demonstrated past performance record of projects similar in nature and complexity to the contract undertaken during the last 20 years concerning the Quality of end-product.</p> <p>Relevant experience is <u>limited</u> to the following:</p> <p>A project of a similar nature to the project in question was executed during (2008-2023) in the following categories only:</p> <ol style="list-style-type: none"> <li>1. Completed Hospital construction project implemented by the applicant. <ul style="list-style-type: none"> <li>• Hospital project should include main functions such as but not limited to ICUs, NICUs, CSSD, Emergency, and operation theaters. <u>A minimum of 60 beds.</u></li> </ul> </li> <li>2. Completed Hospital Expansion and Renovation Project implemented by the applicant. <ul style="list-style-type: none"> <li>• The project should include main functions such as but not limited to ICUs, NICUs, CSSD, Emergency, and operation theaters. <u>A minimum of 60 beds.</u></li> </ul> </li> <li>3. Completed Hospital Expansion Project implemented by the applicant. <ul style="list-style-type: none"> <li>• The project should include main functions such as but not limited to ICUs, NICUs, CSSD, Emergency, and operation theaters. <u>A minimum of 60 beds.</u></li> </ul> </li> <li>4. Completed Hospital Renovation Project implemented by the applicant. <ul style="list-style-type: none"> <li>• The project should include main functions such as but not limited to ICUs, NICUs, CSSD, Emergency, and operation theaters. <u>A minimum of 60 beds.</u></li> </ul> </li> <li>5. Completed Five- or four-stars' hotel project, with a total built up area not less than (15,000 m<sup>2</sup>). Hotel projects should include but not be limited to electromechanical works such as central HVAC, restaurant(s), other hotel facilities, and administrative functions.</li> </ol>	<p>The applicants are required to complete Form 2/a.</p> <p>The maximum score for all projects is 60 points, all applicants are required to provide two similar projects in compliance with similar project requirements as described earlier.</p> <ul style="list-style-type: none"> <li>• Completed Hospital project will be given (30 points)</li> <li>• Completed Hospital Expansion and Renovation project will be given (30 points)</li> <li>• Completed Hospital Expansion project will be given (30 points)</li> <li>• Completed Hospital Renovation project will be given (30 points)</li> <li>• Completed Five or four-stars' hotel project will be given (25 points)</li> <li>• Completed Mall project will be given (20 points)</li> </ul> <p>In case of a Joint- Venture The applicant is required to complete Form 2/b in addition to the above.</p> <p>All applicants are required to provide four similar projects (2 for each party of the JV, each JV party must provide a similar project relevant to their respective scope of work within the project), in compliance with similar project requirements as defined.</p> <ul style="list-style-type: none"> <li>• Hospital project will be given (15 points)</li> <li>• Hospital Expansion and Renovation project will be given (15 points)</li> </ul>
---	--	----	---	--

ADD-9

مهندسة وهاء نايف العالول

مهندس دراسات الانشائية  
المهندسة وهاء نايف العالول

# Request for Prequalification

			<p>6. Completed Mall project, with a total built up area not less than (15,000 m<sup>2</sup>). The project should include but not be limited to electromechanical systems such as central HVAC, and administrative functions.</p> <ul style="list-style-type: none"> <li>• The applicant shall provide official certified Performance Certificates from the owners or Employers for the above listed similar projects indicating the area, scope of work, and the number of beds (for hospital projects).</li> <li>• The Applicant Shall submit signed and stamped documentation from the Owner or Employer including a full description of the submitted project.</li> <li>• If the applicant fails to provide the officially certified Performance Certificates from the Owner or Employer, the project will not be considered.</li> <li>• References to similar completed projects, the applicant shall provide the owner &amp; Supervision/ Consultant firm contact information for reference.</li> <li>• The applicant shall submit Photo documentation for finished buildings.</li> <li>• The GTD has the right to select one or more of the listed projects under this form to be visited during the evaluation process for references and to check the quality of the product on site.</li> </ul>	<ul style="list-style-type: none"> <li>• Hospital Expansion project will be given (15 points)</li> <li>• Hospital Renovation project will be given (15 points)</li> <li>• Five or Four stars hotel project will be given (12.5 points)</li> <li>• Mall project will be given (10 points)</li> </ul> <p><u>Any submission of a project that exceeds the criteria that is specified in the similar projects section shall be granted a maximum of 10 points (the rewarded bonus points are to be determined by the GTD's Technical Committee).</u></p>
--	--	--	---	--

الهيئة العامة للغذاء والدواء  
الهيئة العامة للغذاء والدواء  
الهيئة العامة للغذاء والدواء

ADD-10

مدير دراسات الإنشائية  
المهندسة ولاء نايف العالول

**Princess Muna Al-Hussein Maternity Hospital**

Section (2):- DEMOLITION, EXCAVATION AND SUBSTRUCTURAL WORKS					
ITEM	DESCRIPTION	UNIT	QTY	Unit Price	Total Price
				J.D	J.D
2/11	<p><b>Square meter:</b> Supply, apply and install 4mm one layer torch applied SBS modified bituminous water- proofing membrane, (polyester reinforced bitumen 200gm/m<sup>2</sup> membrane). Thickness of the membrane 4 mm thick (accepted tolerance= ±5%). The price to include but not limited all products, materials, prime coat, 10 cm minimum overlap between rolls, joint sealant, pointing with mastic, all stainless accessories, fixation, installation, protection and all needed to complete the work as per the drawings and technical specifications.</p> <p>Measurement for the real executed areas without measured the overlaps. No deduction shall be made for voids less than 0.5 m<sup>2</sup></p> <p>1- For basement walls and wherever required as per the drawings. Four Thousand Four Hundred Sixty</p>	M2	4460		
THE TOTAL MUST CARRY TO THE SECTION COLLECTION PAGE					

Princess Muna Al-Hussein Maternity Hospital

Section (8):- PAINTING					
ITEM	DESCRIPTION	UNIT	QTY	Unit Price	Total Price
				J.D	J.D
8/4	<p><b>Square Meter:</b></p> <p>Prepare, supply and apply anti-bacterial epoxy paint (thick film paint system) thickness 300 micron.</p> <p>-The contractor must submit certified copy for the suggested paint to prove that the paint's components are antibacterial suitable for hospitals and healthcare</p> <p>- paint materials must be approved by the engineer</p> <p>- the paint must be washable and easy to clean surface.</p> <p>- the paint, primer, putty, binder, carrier must be compatible and complying with the manufacturer instructions (healthcare)</p> <p>The price includes the epoxy paint of 300 micron with all putty and primer coats and layers.</p> <p>Price to include:</p> <p>- Prepare surfaces (rubbed down smooth)</p> <p>- Primer coat (bonding agent)</p> <p>- Two coats of putty (putty shall be grinded and well smoothed)</p> <p>- One coat of under coat (base coat)</p> <p>complete as shown on drawings, and as per Technical Specifications and manufacture instructions</p> <p>The measurement for the execution area as required in the drawings.</p> <p>a- for walls.</p> <p>One Thousand Eight Hundred</p> <p>b- For Ceiling</p> <p>Fifty</p>	M2	1800		
		M2	50		
THE TOTAL MUST CARRY TO THE SECTION COLLECTION PAGE					

PAINT

ADD Arch. Civil - 86

مدير دراسات الابنية  
الهندسة وهاء نايف المالول

NOTES

1. ALL DIMENSIONS ARE UNLESS OTHERWISE NOTED.
2. ALL DIMENSIONS ARE IN METERS.
3. THE BASEMENT FLOOR IS 1.50 M. BELOW THE FINISHED GROUND LEVEL.
4. THE FINISHED GROUND LEVEL IS 100.00 M.

NO.	DESCRIPTION	QTY	UNIT
1	CONCRETE	100.00	M <sup>3</sup>
2	STEEL	10.00	T
3	BRICK	100.00	M <sup>3</sup>
4	CEMENT	100.00	M <sup>3</sup>
5	SAND	100.00	M <sup>3</sup>
6	GRAVEL	100.00	M <sup>3</sup>
7	WATER	100.00	M <sup>3</sup>
8	ELECTRICITY	100.00	M <sup>3</sup>
9	TELEPHONE	100.00	M <sup>3</sup>
10	HEATING	100.00	M <sup>3</sup>
11	Cooling	100.00	M <sup>3</sup>
12	Lighting	100.00	M <sup>3</sup>
13	Sound	100.00	M <sup>3</sup>
14	Security	100.00	M <sup>3</sup>
15	Fire	100.00	M <sup>3</sup>
16	Other	100.00	M <sup>3</sup>

ملاحظات

Final Tender Document



Jordanian Royal Medical Services



United States Agency for International Development



PRINCESS MUNA AL-HUSSEINI MATERNITY HOSPITAL



BTRC CONSULTANTS



PRINCESS MUNA AL-HUSSEINI MATERNITY HOSPITAL



PRINCESS MUNA AL-HUSSEINI MATERNITY HOSPITAL



PRINCESS MUNA AL-HUSSEINI MATERNITY HOSPITAL

بيلار BILAR CONSULTANTS

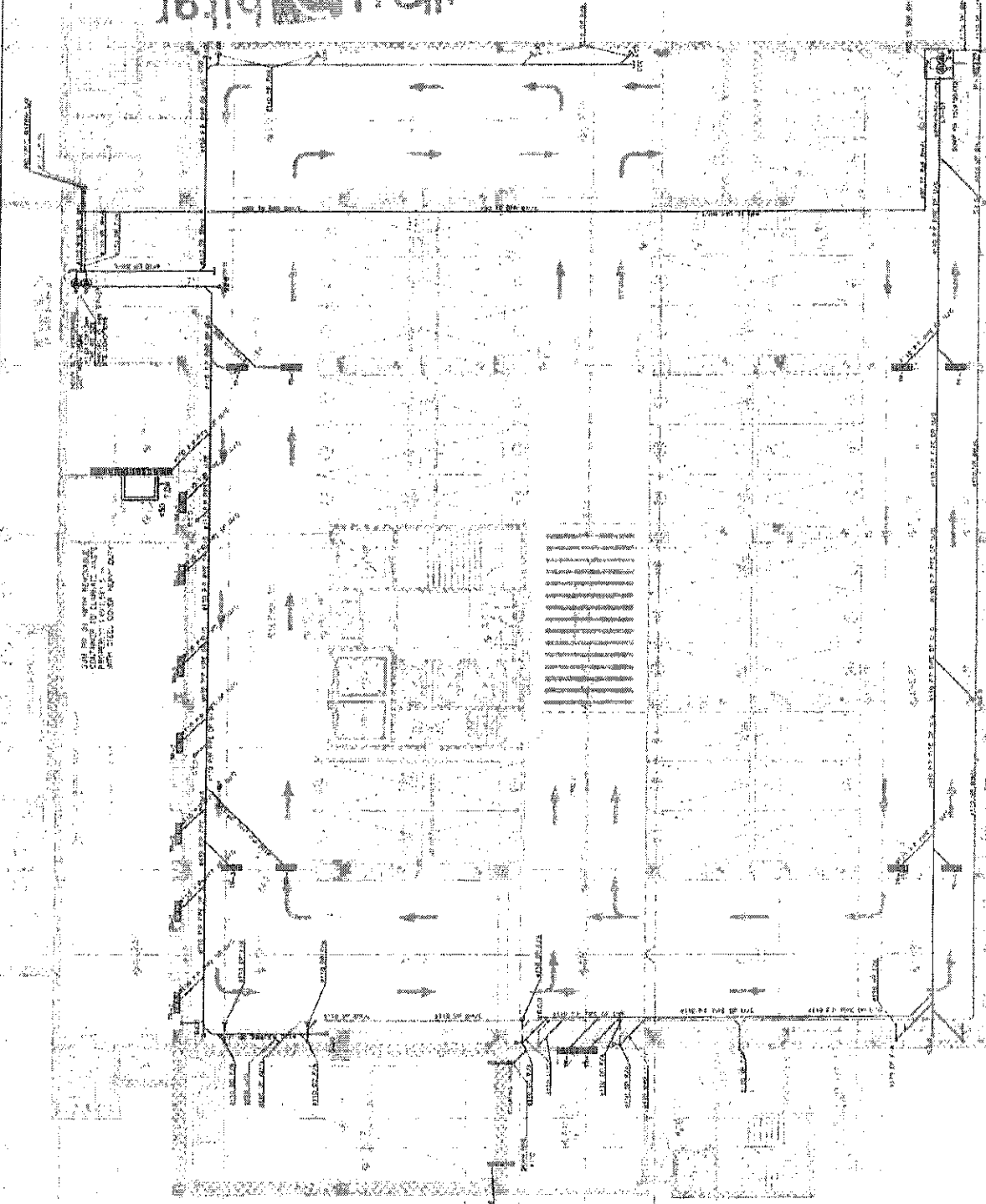

مهندس دراستات الأبنية  
المهندس سارة وفاء نايف الصالحول





**NOTES:**

1. All dimensions are in meters.
2. All dimensions are in meters.
3. All dimensions are in meters.
4. All dimensions are in meters.
5. All dimensions are in meters.
6. All dimensions are in meters.
7. All dimensions are in meters.
8. All dimensions are in meters.
9. All dimensions are in meters.
10. All dimensions are in meters.
11. All dimensions are in meters.
12. All dimensions are in meters.
13. All dimensions are in meters.
14. All dimensions are in meters.
15. All dimensions are in meters.
16. All dimensions are in meters.
17. All dimensions are in meters.
18. All dimensions are in meters.
19. All dimensions are in meters.
20. All dimensions are in meters.
21. All dimensions are in meters.
22. All dimensions are in meters.
23. All dimensions are in meters.
24. All dimensions are in meters.
25. All dimensions are in meters.
26. All dimensions are in meters.
27. All dimensions are in meters.
28. All dimensions are in meters.
29. All dimensions are in meters.
30. All dimensions are in meters.
31. All dimensions are in meters.
32. All dimensions are in meters.
33. All dimensions are in meters.
34. All dimensions are in meters.
35. All dimensions are in meters.
36. All dimensions are in meters.
37. All dimensions are in meters.
38. All dimensions are in meters.
39. All dimensions are in meters.
40. All dimensions are in meters.
41. All dimensions are in meters.
42. All dimensions are in meters.
43. All dimensions are in meters.
44. All dimensions are in meters.
45. All dimensions are in meters.
46. All dimensions are in meters.
47. All dimensions are in meters.
48. All dimensions are in meters.
49. All dimensions are in meters.
50. All dimensions are in meters.
51. All dimensions are in meters.
52. All dimensions are in meters.
53. All dimensions are in meters.
54. All dimensions are in meters.
55. All dimensions are in meters.
56. All dimensions are in meters.
57. All dimensions are in meters.
58. All dimensions are in meters.
59. All dimensions are in meters.
60. All dimensions are in meters.
61. All dimensions are in meters.
62. All dimensions are in meters.
63. All dimensions are in meters.
64. All dimensions are in meters.
65. All dimensions are in meters.
66. All dimensions are in meters.
67. All dimensions are in meters.
68. All dimensions are in meters.
69. All dimensions are in meters.
70. All dimensions are in meters.
71. All dimensions are in meters.
72. All dimensions are in meters.
73. All dimensions are in meters.
74. All dimensions are in meters.
75. All dimensions are in meters.
76. All dimensions are in meters.
77. All dimensions are in meters.
78. All dimensions are in meters.
79. All dimensions are in meters.
80. All dimensions are in meters.
81. All dimensions are in meters.
82. All dimensions are in meters.
83. All dimensions are in meters.
84. All dimensions are in meters.
85. All dimensions are in meters.
86. All dimensions are in meters.
87. All dimensions are in meters.
88. All dimensions are in meters.
89. All dimensions are in meters.
90. All dimensions are in meters.
91. All dimensions are in meters.
92. All dimensions are in meters.
93. All dimensions are in meters.
94. All dimensions are in meters.
95. All dimensions are in meters.
96. All dimensions are in meters.
97. All dimensions are in meters.
98. All dimensions are in meters.
99. All dimensions are in meters.
100. All dimensions are in meters.

**Final Tender Document**

**USAID**

**PRINCESS MUNA AH-HUSSEIN MATERNITY HOSPITAL**

**First Basement Floor Drainage System**

**Drainage System**

**Sheet No. 2029**

**Scale: 1:100**

**400**

**4204**

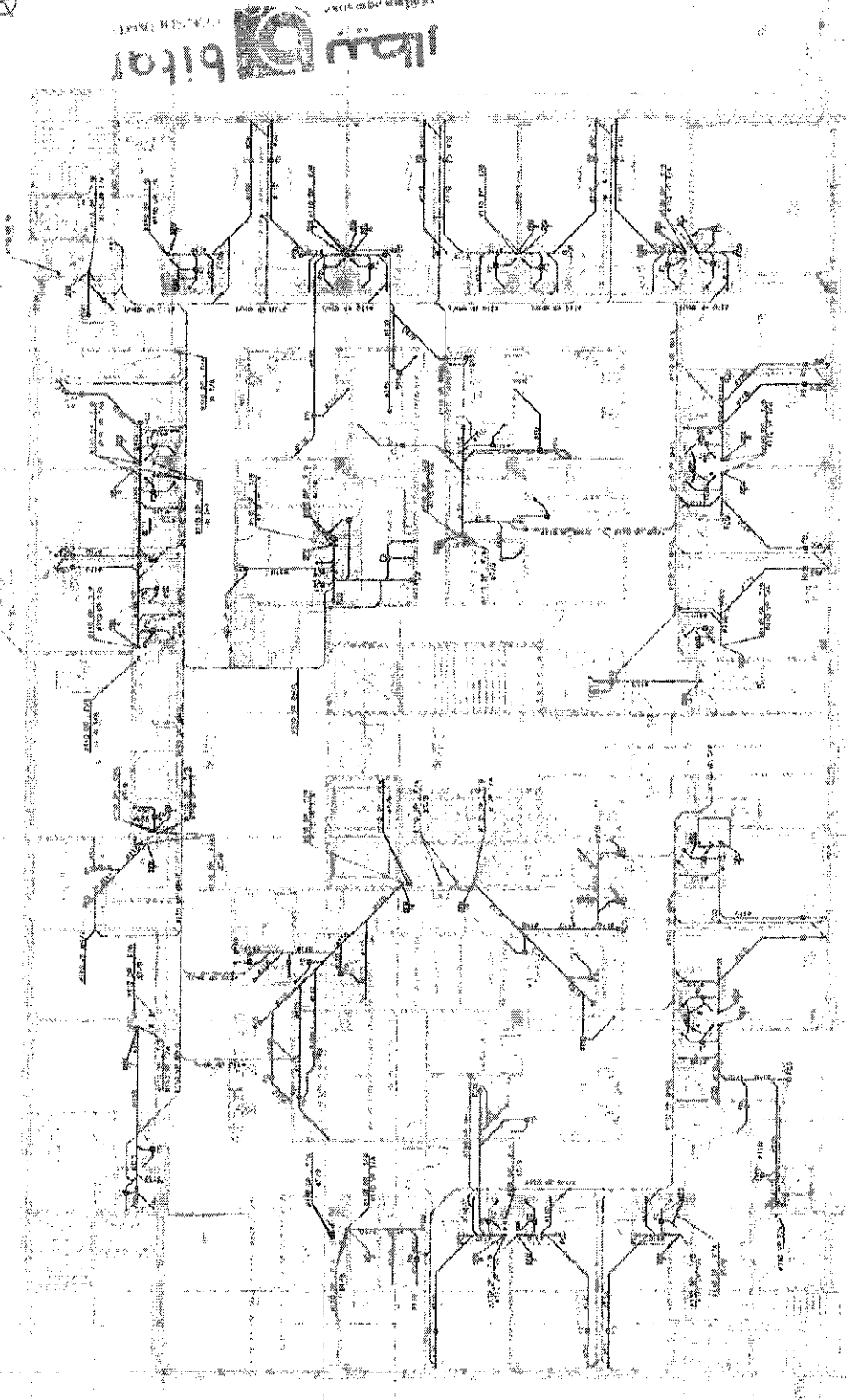

مهندس مرصعات الأبنية  
المهندسة ولالة دايف الصالح

NOTE  
1. All dimensions are in feet and inches.  
2. All dimensions are to center line.  
3. All dimensions are to finished surface.  
4. The location of walls and doors is shown.  
5. The location of stairs and elevators is shown.  
6. The location of windows and doors is shown.  
7. The location of doors and windows is shown.  
8. The location of doors and windows is shown.

1	2	3	4	5	6	7	8	9	10	11	12	13	14	15	16	17	18	19	20	21	22	23	24	25	26	27	28	29	30	31	32	33	34	35	36	37	38	39	40	41	42	43	44	45	46	47	48	49	50	51	52	53	54	55	56	57	58	59	60	61	62	63	64	65	66	67	68	69	70	71	72	73	74	75	76	77	78	79	80	81	82	83	84	85	86	87	88	89	90	91	92	93	94	95	96	97	98	99	100
---	---	---	---	---	---	---	---	---	----	----	----	----	----	----	----	----	----	----	----	----	----	----	----	----	----	----	----	----	----	----	----	----	----	----	----	----	----	----	----	----	----	----	----	----	----	----	----	----	----	----	----	----	----	----	----	----	----	----	----	----	----	----	----	----	----	----	----	----	----	----	----	----	----	----	----	----	----	----	----	----	----	----	----	----	----	----	----	----	----	----	----	----	----	----	----	----	----	----	-----

Final Tender Document  
Jordanian Royal Medical Services



United States Agency for International Development  
USAID

PRINCESS MUNA AHUSSEIN MATERNITY HOSPITAL  
King Hussein Medical Center / Jordan

Grand Floor  
Drainage System  
A1

14205

1	2	3	4	5	6	7	8	9	10	11	12	13	14	15	16	17	18	19	20	21	22	23	24	25	26	27	28	29	30	31	32	33	34	35	36	37	38	39	40	41	42	43	44	45	46	47	48	49	50	51	52	53	54	55	56	57	58	59	60	61	62	63	64	65	66	67	68	69	70	71	72	73	74	75	76	77	78	79	80	81	82	83	84	85	86	87	88	89	90	91	92	93	94	95	96	97	98	99	100
---	---	---	---	---	---	---	---	---	----	----	----	----	----	----	----	----	----	----	----	----	----	----	----	----	----	----	----	----	----	----	----	----	----	----	----	----	----	----	----	----	----	----	----	----	----	----	----	----	----	----	----	----	----	----	----	----	----	----	----	----	----	----	----	----	----	----	----	----	----	----	----	----	----	----	----	----	----	----	----	----	----	----	----	----	----	----	----	----	----	----	----	----	----	----	----	----	----	----	-----

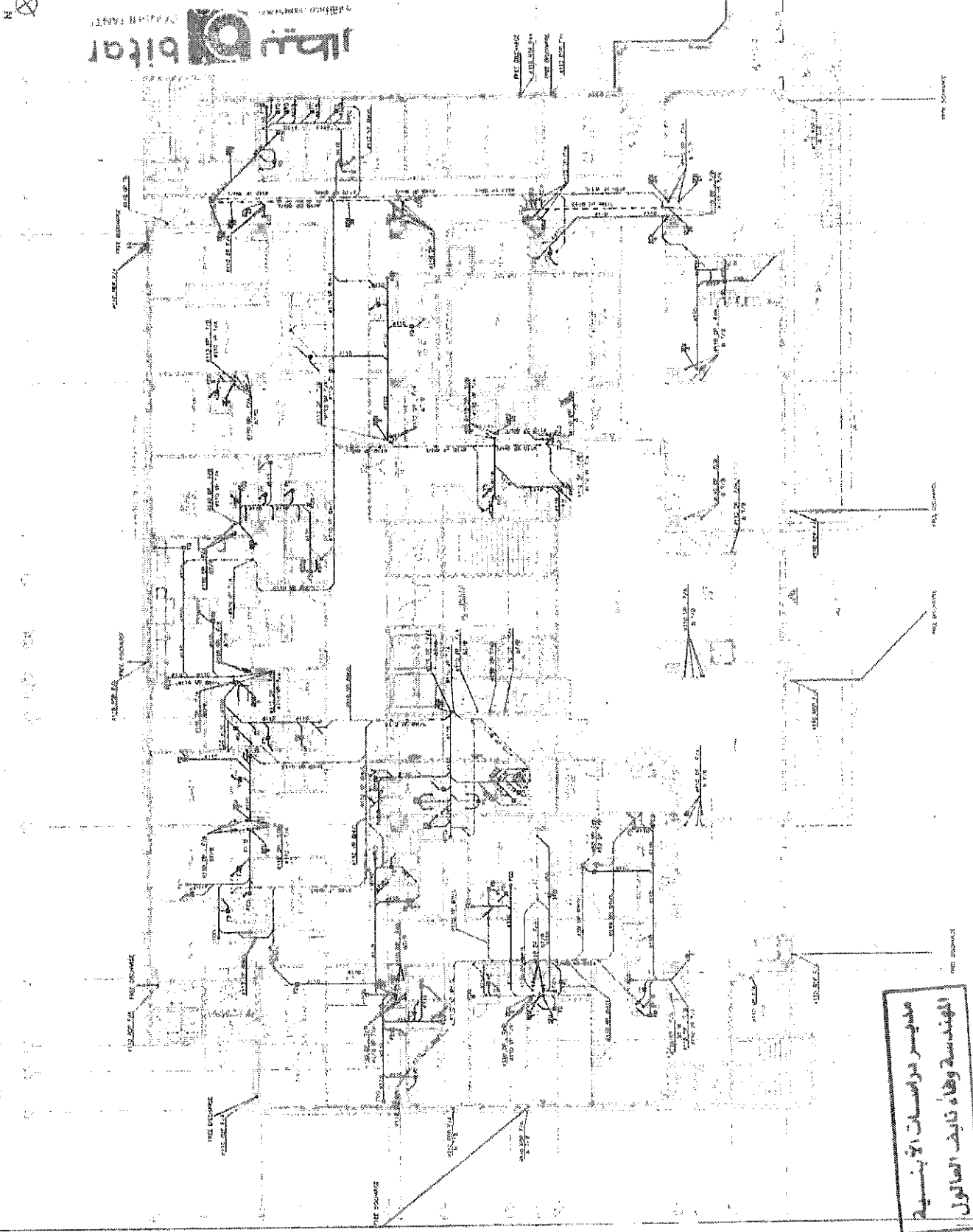

مهندس دراستات الانشائية  
المهندس وهاب ثابت الصالحول

مهندس دراسات الأبنية  
المهندسة ولاء فايف العالول

بیتار  
bitar

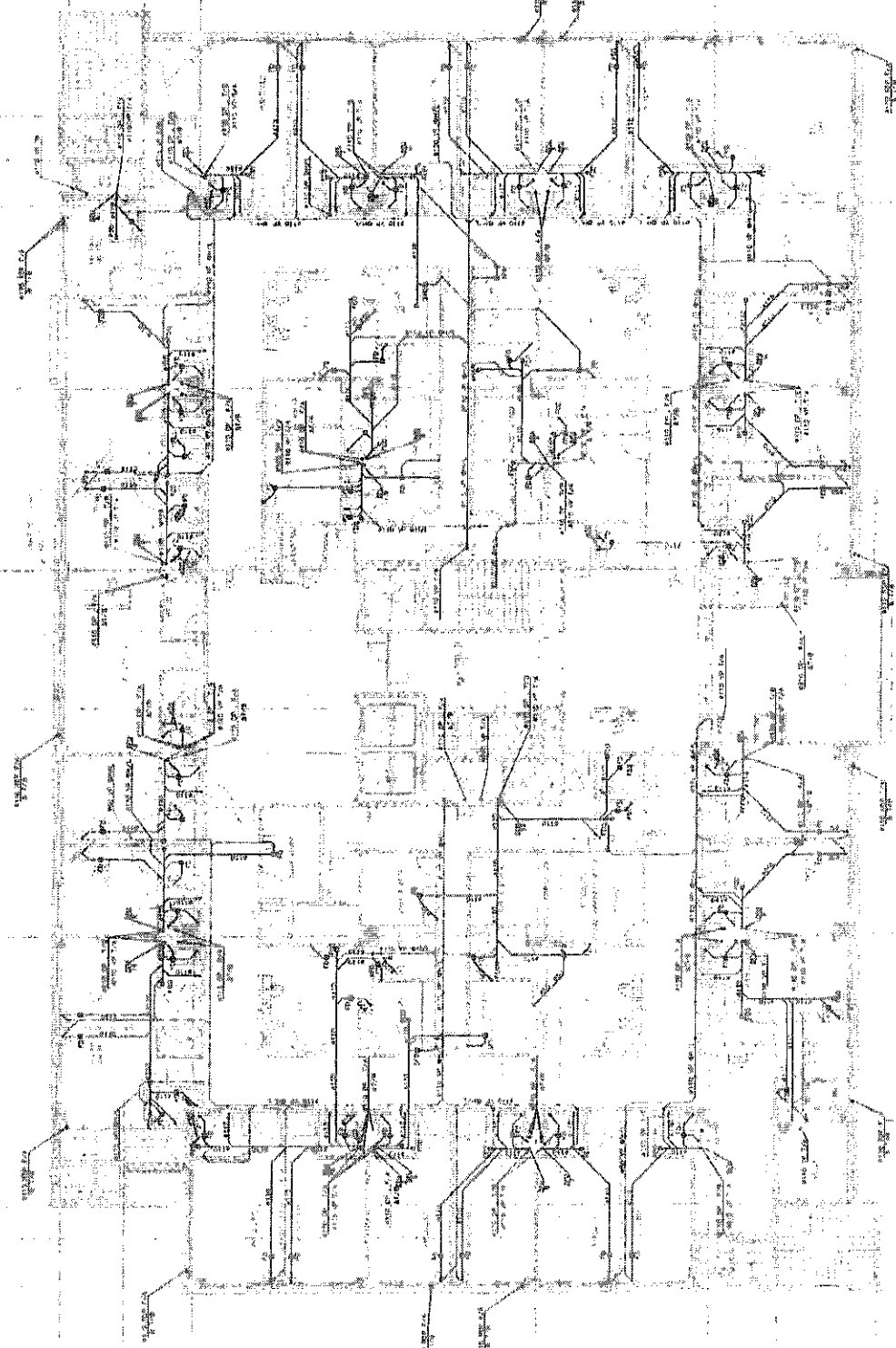

<b>NOTES</b> 1. ALL DIMENSIONS ARE IN METERS. 2. ALL DIMENSIONS ARE TO FACE UNLESS OTHERWISE SPECIFIED. 3. ALL DIMENSIONS ARE TO FACE UNLESS OTHERWISE SPECIFIED. 4. ALL DIMENSIONS ARE TO FACE UNLESS OTHERWISE SPECIFIED. 5. ALL DIMENSIONS ARE TO FACE UNLESS OTHERWISE SPECIFIED.		<b>Final Tender Document</b> Jordanian Royal Medical Services		<b>USAID</b> United States Agency for International Development		<b>BITAR CONSULTANTS</b> Architect, Engineering & Project Management 100 King Abdullah Street, Amman, Jordan Tel: 962 622 1111 Fax: 962 622 1112 Email: bitar@bitar.jo		<b>PRINCESS MUNIA AL-ABASEIN MATERNITY HOSPITAL</b> King Hussein Medical Center, Amman, Jordan		<b>First Floor Drainage System</b> 2002 A1 1/2005	
--	--	--	--	--	--	---	--	---	--	--	--

[illegible]

Case 102	102499
Case 103	41292
Case 104	10491
Case 105	10591
Case 106	10691
Case 107	10791
Case 108	10891
Case 109	10991
Case 110	11091
Case 111	11191
Case 112	11291
Case 113	11391
Case 114	11491
Case 115	11591
Case 116	11691
Case 117	11791
Case 118	11891
Case 119	11991
Case 120	12091
Case 121	12191
Case 122	12291
Case 123	12391
Case 124	12491
Case 125	12591
Case 126	12691
Case 127	12791
Case 128	12891
Case 129	12991
Case 130	13091
Case 131	13191
Case 132	13291
Case 133	13391
Case 134	13491
Case 135	13591
Case 136	13691
Case 137	13791
Case 138	13891
Case 139	13991
Case 140	14091
Case 141	14191
Case 142	14291
Case 143	14391
Case 144	14491
Case 145	14591
Case 146	14691
Case 147	14791
Case 148	14891
Case 149	14991
Case 150	15091
Case 151	15191
Case 152	15291
Case 153	15391
Case 154	15491
Case 155	15591
Case 156	15691
Case 157	15791
Case 158	15891
Case 159	15991
Case 160	16091
Case 161	16191
Case 162	16291
Case 163	16391
Case 164	16491
Case 165	16591
Case 166	16691
Case 167	16791
Case 168	16891
Case 169	16991
Case 170	17091
Case 171	17191
Case 172	17291
Case 173	17391
Case 174	17491
Case 175	17591
Case 176	17691
Case 177	17791
Case 178	17891
Case 179	17991
Case 180	18091
Case 181	18191
Case 182	18291
Case 183	18391
Case 184	18491
Case 185	18591
Case 186	18691
Case 187	18791
Case 188	18891
Case 189	18991
Case 190	19091
Case 191	19191
Case 192	19291
Case 193	19391
Case 194	19491
Case 195	19591
Case 196	19691
Case 197	19791
Case 198	19891
Case 199	19991
Case 200	20091

[illegible]

23	STP - 224111 PLATE 0049
24	NO. 0049 WITH PLATE
25	NO. 0049 PLATE
26	NO. 0049 PLATE
27	NO. 0049 PLATE

[illegible]

Final Tender Document

United States Agency for  
International Development

1900-1901  
 1902-1903  
 1904-1905  
 1906-1907  
 1908-1909  
 1910-1911  
 1912-1913  
 1914-1915  
 1916-1917  
 1918-1919  
 1920-1921  
 1922-1923  
 1924-1925  
 1926-1927  
 1928-1929  
 1930-1931  
 1932-1933  
 1934-1935  
 1936-1937  
 1938-1939  
 1940-1941  
 1942-1943  
 1944-1945  
 1946-1947  
 1948-1949  
 1950-1951  
 1952-1953  
 1954-1955  
 1956-1957  
 1958-1959  
 1960-1961  
 1962-1963  
 1964-1965  
 1966-1967  
 1968-1969  
 1970-1971  
 1972-1973  
 1974-1975  
 1976-1977  
 1978-1979  
 1980-1981  
 1982-1983  
 1984-1985  
 1986-1987  
 1988-1989  
 1990-1991  
 1992-1993  
 1994-1995  
 1996-1997  
 1998-1999  
 2000-2001  
 2002-2003  
 2004-2005  
 2006-2007  
 2008-2009  
 2010-2011  
 2012-2013  
 2014-2015  
 2016-2017  
 2018-2019  
 2020-2021  
 2022-2023  
 2024-2025  
 2026-2027  
 2028-2029  
 2030-2031  
 2032-2033  
 2034-2035  
 2036-2037  
 2038-2039  
 2040-2041  
 2042-2043  
 2044-2045  
 2046-2047  
 2048-2049  
 2050-2051  
 2052-2053  
 2054-2055  
 2056-2057  
 2058-2059  
 2060-2061  
 2062-2063  
 2064-2065  
 2066-2067  
 2068-2069  
 2070-2071  
 2072-2073  
 2074-2075  
 2076-2077  
 2078-2079  
 2080-2081  
 2082-2083  
 2084-2085  
 2086-2087  
 2088-2089  
 2090-2091  
 2092-2093  
 2094-2095  
 2096-2097  
 2098-2099  
 2100-2101  
 2102-2103  
 2104-2105  
 2106-2107  
 2108-2109  
 2110-2111  
 2112-2113  
 2114-2115  
 2116-2117  
 2118-2119  
 2120-2121  
 2122-2123  
 2124-2125  
 2126-2127  
 2128-2129  
 2130-2131  
 2132-2133  
 2134-2135  
 2136-2137  
 2138-2139  
 2140-2141  
 2142-2143  
 2144-2145  
 2146-2147  
 2148-2149  
 2150-2151  
 2152-2153  
 2154-2155  
 2156-2157  
 2158-2159  
 2160-2161  
 2162-2163  
 2164-2165  
 2166-2167  
 2168-2169  
 2170-2171  
 2172-2173  
 2174-2175  
 2176-2177  
 2178-2179  
 2180-2181  
 2182-2183  
 2184-2185  
 2186-2187  
 2188-2189  
 2190-2191  
 2192-2193  
 2194-2195  
 2196-2197  
 2198-2199  
 2200-2201  
 2202-2203  
 2204-2205  
 2206-2207  
 2208-2209  
 2210-2211  
 2212-2213  
 2214-2215  
 2216-2217  
 2218-2219  
 2220-2221  
 2222-2223  
 2224-2225  
 2226-2227  
 2228-2229  
 2230-2231  
 2232-2233  
 2234-2235  
 2236-2237  
 2238-2239  
 2240-2241  
 2242-2243  
 2244-2245  
 2246-2247  
 2248-2249  
 2250-2251  
 2252-2253  
 2254-2255  
 2256-2257  
 2258-2259  
 2260-2261  
 2262-2263  
 2264-2265  
 2266-2267  
 2268-2269  
 2270-2271  
 2272-2273  
 2274-2275  
 2276-2277  
 2278-2279  
 2280-2281  
 2282-2283  
 2284-2285  
 2286-2287  
 2288-2289  
 2290-2291  
 2292-2293  
 2294-2295  
 2296-2297  
 2298-2299  
 2300-2301  
 2302-2303  
 2304-2305  
 2306-2307  
 2308-2309  
 2310-2311  
 2312-2313  
 2314-2315  
 2316-2317  
 2318-2319  
 2320-2321  
 2322-2323  
 2324-2325  
 2326-2327  
 2328-2329  
 2330-2331  
 2332-2333  
 2334-2335  
 2336-2337  
 2338-2339  
 2340-2341  
 2342-2343  
 2344-2345  
 2346-2347  
 2348-2349  
 2350-2351  
 2352-2353  
 2354-2355  
 2356-2357  
 2358-2359  
 2360-2361  
 2362-2363  
 2364-2365  
 2366-2367  
 2368-2369  
 2370-2371  
 2372-2373  
 2374-2375  
 2376-2377  
 2378-2379  
 2380-2381  
 2382-2383  
 2384-2385  
 2386-2387  
 2388-2389  
 2390-2391  
 2392-2393  
 2394-2395  
 2396-2397  
 2398-2399  
 2400-2401  
 2402-2403  
 2404-2405  
 2406-2407  
 2408-2409  
 2410-2411  
 2412-2413  
 2414-2415  
 2416-2417  
 2418-2419  
 2420-2421  
 2422-2423  
 2424-2425  
 2426-2427  
 2428-2429  
 2430-2431  
 2432-2433  
 2434-2435  
 2436-2437  
 2438-2439  
 2440-2441  
 2442-2443  
 2444-2445  
 2446-2447  
 2448-2449  
 2450-2451  
 2452-2453  
 2454-2455  
 2456-2457  
 2458-2459  
 2460-2461  
 2462-2463  
 2464-2465  
 2466-2467  
 2468-2469  
 2470-2471  
 2472-2473  
 2474-2475  
 2476-2477  
 2478-2479  
 2480-2481  
 2482-2483  
 248

MATERNITY HOSPITAL 1000 Municipal Building St. Louis, Mo. 63103	Exp. Date 5/1975	Second Floor Drainage System
	Project 1023	

[illegible]

**Final Tender Document**

**Medical Records - Area Left**

**San Royal Medical Services**

United States Agency for  
International Development  
USA

[illegible]

PRINCESS MILVA AL-ALUSSEIN  
MATERNITY HOSPITAL  
Abdo Moustafa Shams El-Dine | Director

[illegible]

Second-Phase Drainage System	Drainage System	Drainage System	Drainage System
Drainage System	Drainage System	Drainage System	Drainage System

11662	2018	1207
2146	2018	1207

N

bilmar

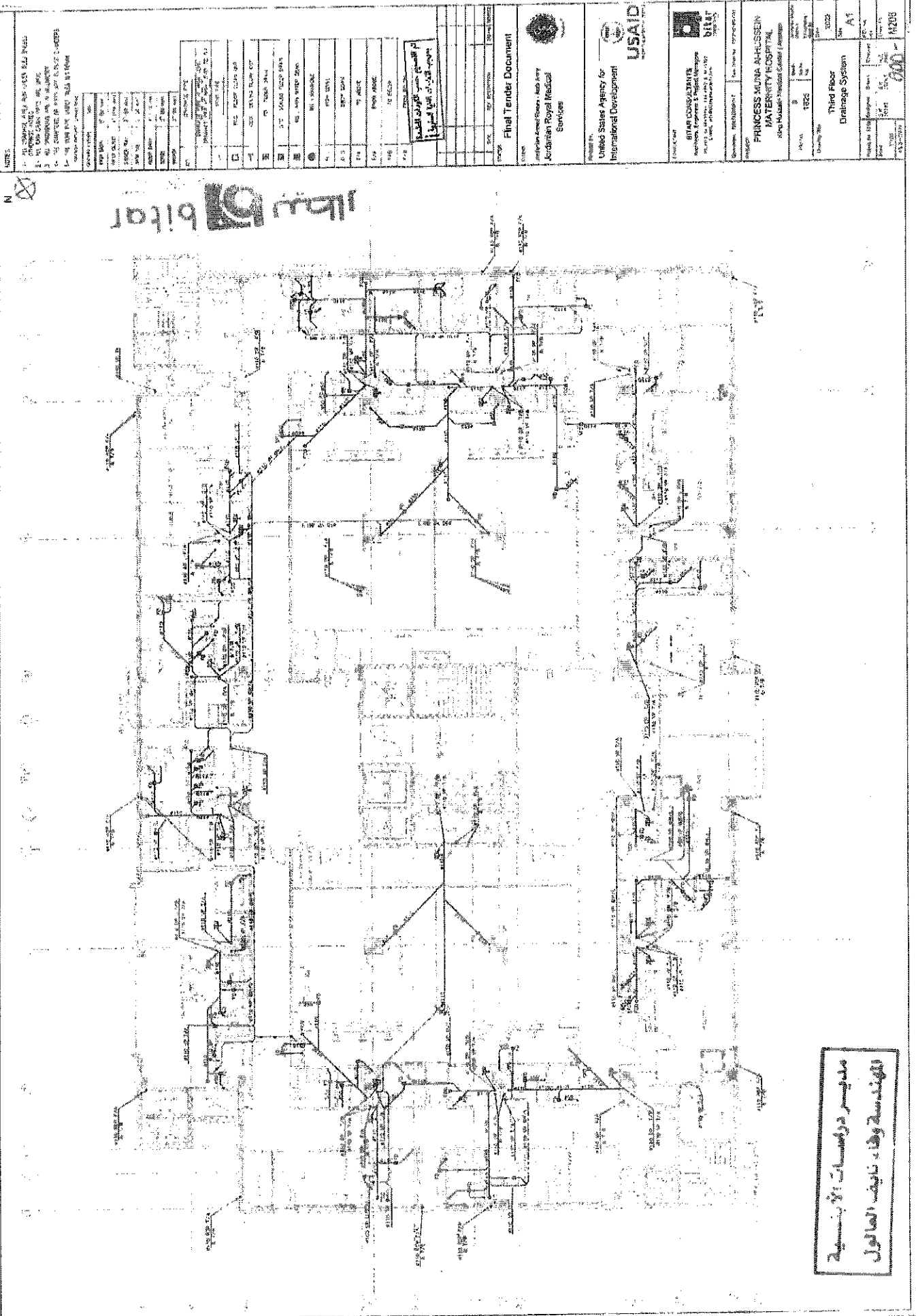

NOTES:  
1. ALL DIMENSIONS ARE IN METERS  
2. ALL DIMENSIONS ARE TO FACE  
3. ALL DIMENSIONS ARE TO CENTER  
4. ALL DIMENSIONS ARE TO CENTER  
5. ALL DIMENSIONS ARE TO CENTER

NO.	DESCRIPTION	QTY	UNIT
1	CEILING	1.00	SQ. M.
2	FLOOR	1.00	SQ. M.
3	WALL	1.00	SQ. M.
4	DOOR	1.00	NO.
5	WINDOW	1.00	NO.
6	STAIR	1.00	SQ. M.
7	ROOF	1.00	SQ. M.
8	FOUNDATION	1.00	SQ. M.
9	CONCRETE	1.00	SQ. M.
10	STEEL	1.00	SQ. M.
11	GLASS	1.00	SQ. M.
12	PAINT	1.00	SQ. M.
13	PLASTER	1.00	SQ. M.
14	CEILING	1.00	SQ. M.
15	FLOOR	1.00	SQ. M.
16	WALL	1.00	SQ. M.
17	DOOR	1.00	NO.
18	WINDOW	1.00	NO.
19	STAIR	1.00	SQ. M.
20	ROOF	1.00	SQ. M.
21	FOUNDATION	1.00	SQ. M.
22	CONCRETE	1.00	SQ. M.
23	STEEL	1.00	SQ. M.
24	GLASS	1.00	SQ. M.
25	PAINT	1.00	SQ. M.
26	PLASTER	1.00	SQ. M.
27	CEILING	1.00	SQ. M.
28	FLOOR	1.00	SQ. M.
29	WALL	1.00	SQ. M.
30	DOOR	1.00	NO.
31	WINDOW	1.00	NO.
32	STAIR	1.00	SQ. M.
33	ROOF	1.00	SQ. M.
34	FOUNDATION	1.00	SQ. M.
35	CONCRETE	1.00	SQ. M.
36	STEEL	1.00	SQ. M.
37	GLASS	1.00	SQ. M.
38	PAINT	1.00	SQ. M.
39	PLASTER	1.00	SQ. M.
40	CEILING	1.00	SQ. M.
41	FLOOR	1.00	SQ. M.
42	WALL	1.00	SQ. M.
43	DOOR	1.00	NO.
44	WINDOW	1.00	NO.
45	STAIR	1.00	SQ. M.
46	ROOF	1.00	SQ. M.
47	FOUNDATION	1.00	SQ. M.
48	CONCRETE	1.00	SQ. M.
49	STEEL	1.00	SQ. M.
50	GLASS	1.00	SQ. M.
51	PAINT	1.00	SQ. M.
52	PLASTER	1.00	SQ. M.
53	CEILING	1.00	SQ. M.
54	FLOOR	1.00	SQ. M.
55	WALL	1.00	SQ. M.
56	DOOR	1.00	NO.
57	WINDOW	1.00	NO.
58	STAIR	1.00	SQ. M.
59	ROOF	1.00	SQ. M.
60	FOUNDATION	1.00	SQ. M.
61	CONCRETE	1.00	SQ. M.
62	STEEL	1.00	SQ. M.
63	GLASS	1.00	SQ. M.
64	PAINT	1.00	SQ. M.
65	PLASTER	1.00	SQ. M.
66	CEILING	1.00	SQ. M.
67	FLOOR	1.00	SQ. M.
68	WALL	1.00	SQ. M.
69	DOOR	1.00	NO.
70	WINDOW	1.00	NO.
71	STAIR	1.00	SQ. M.
72	ROOF	1.00	SQ. M.
73	FOUNDATION	1.00	SQ. M.
74	CONCRETE	1.00	SQ. M.
75	STEEL	1.00	SQ. M.
76	GLASS	1.00	SQ. M.
77	PAINT	1.00	SQ. M.
78	PLASTER	1.00	SQ. M.
79	CEILING	1.00	SQ. M.
80	FLOOR	1.00	SQ. M.
81	WALL	1.00	SQ. M.
82	DOOR	1.00	NO.
83	WINDOW	1.00	NO.
84	STAIR	1.00	SQ. M.
85	ROOF	1.00	SQ. M.
86	FOUNDATION	1.00	SQ. M.
87	CONCRETE	1.00	SQ. M.
88	STEEL	1.00	SQ. M.
89	GLASS	1.00	SQ. M.
90	PAINT	1.00	SQ. M.
91	PLASTER	1.00	SQ. M.
92	CEILING	1.00	SQ. M.
93	FLOOR	1.00	SQ. M.
94	WALL	1.00	SQ. M.
95	DOOR	1.00	NO.
96	WINDOW	1.00	NO.
97	STAIR	1.00	SQ. M.
98	ROOF	1.00	SQ. M.
99	FOUNDATION	1.00	SQ. M.
100	CONCRETE	1.00	SQ. M.

Final Tender Document  
Jordanian Royal Medical Services

United States Agency for International Development  
USAID

PRINCESS MUNA AL-HUSSEIN MATERNITY HOSPITAL  
King Hussein Medical Center / Amman

Third Floor  
Drainage System

1000  
A1  
M205

مدير دراسات الأبنية  
الهندسة والبناء نايف العالول





Handwritten note:

Handwritten note: [illegible]

10	2014-15-16	2015	2016
11	2015-16-17	2016	2017
12	2016-17-18	2017	2018
13	2017-18-19	2018	2019
14	2018-19-20	2019	2020
15	2019-20-21	2020	2021
16	2020-21-22	2021	2022
17	2021-22-23	2022	2023
18	2022-23-24	2023	2024
19	2023-24-25	2024	2025
20	2024-25-26	2025	2026
21	2025-26-27	2026	2027
22	2026-27-28	2027	2028
23	2027-28-29	2028	2029
24	2028-29-30	2029	2030
25	2029-30-31	2030	2031
26	2030-31-32	2031	2032
27	2031-32-33	2032	2033
28	2032-33-34	2033	2034
29	2033-34-35	2034	2035
30	2034-35-36	2035	2036
31	2035-36-37	2036	2037
32	2036-37-38	2037	2038
33	2037-38-39	2038	2039
34	2038-39-40	2039	2040
35	2039-40-41	2040	2041
36	2040-41-42	2041	2042
37	2041-42-43	2042	2043
38	2042-43-44	2043	2044
39	2043-44-45	2044	2045
40	2044-45-46	2045	2046
41	2045-46-47	2046	2047
42	2046-47-48	2047	2048
43	2047-48-49	2048	2049
44	2048-49-50	2049	2050
45	2049-50-51	2050	2051
46	2050-51-52	2051	2052
47	2051-52-53	2052	2053
48	2052-53-54	2053	2054
49	2053-54-55	2054	2055
50	2054-55-56	2055	2056
51	2055-56-57	2056	2057
52	2056-57-58	2057	2058
53	2057-58-59	2058	2059
54	2058-59-60	2059	2060
55	2059-60-61	2060	2061
56	2060-61-62	2061	2062
57	2061-62-63	2062	2063
58	2062-63-64	2063	2064
59	2063-64-65	2064	2065
60	2064-65-66	2065	2066
61	2065-66-67	2066	2067
62	2066-67-68	2067	2068
63	2067-68-69	2068	2069
64	2068-69-70	2069	2070
65	2069-70-71	2070	2071
66	2070-71-72	2071	2072
67	2071-72-73	2072	2073
68	2072-73-74	2073	2074
69	2073-74-75	2074	2075
70	2074-75-76	2075	2076
71	2075-76-77	2076	2077
72	2076-77-78	2077	2078
73	2077-78-79	2078	2079
74	2078-79-80	2079	2080
75	2079-80-81	2080	2081
76	2080-81-82	2081	2082
77	2081-82-83	2082	2083
78	2082-83-84	2083	2084
79	2083-84-85	2084	2085
80	2084-85-86	2085	2086
81	2085-86-87	2086	2087
82	2086-87-88	2087	2088
83	2087-88-89	2088	2089
84	2088-89-90	2089	2090
85	2089-90-91	2090	2091
86	2090-91-92	2091	2092
87	2091-92-93	2092	2093
88	2092-93-94	2093	2094
89	2093-94-95	2094	2095
90			

United States Agency for  
International Development

**BINAR CONSULTANTS**  
Architects, Engineers & Program Managers  
701 N. 17th St., Suite 1000  
Tulsa, OK 74103  
(918) 438-1111

**PRINCESS MUHA AL-JUSSEI**  
**MATERNITY HOSPITAL**  
King Hussein Medical Center / Amman

المهندسة وط. نايفت العالمول  
مها فوسل والأستاذات الأخصائية